



Digital Controller

EN INSTRUCTION MANUAL

Thank you for purchasing the OMRON ES6C Digital Controller. This manual describes the functions, performance, and application methods required for optimum use of the product.

OMRON Corporation All Rights Reserved

Refer to the ES6C-Digital Controllers User's Manual (Cat. No. H174) for detailed application procedures.

Safety Precautions

Key to Warning Symbols: Indicates a potentially hazardous situation which, if not avoided, is likely to result in minor or moderate injury or property damage.

Wiring Dimensions

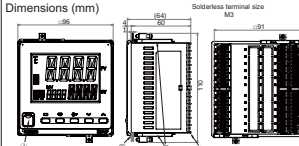

Do not remove the terminal block. Doing so may result in failure or malfunction. Setup Tools parts are provided on the top and front of the Digital Controller.

Names of Parts on Front Panel

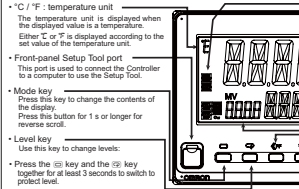

Operation Menu

Input Type

Table with columns: Input Type, Input, Setting, Setting range. Lists various sensors like Platinum Resistance Thermometer, JPt100, K, T, F, N, R, B, S, I, Infrared Thermistors, Current input, Voltage input.

Alarms

Table with columns: Setting, Alarm type, Alarm output function, Alarm output function (X), Alarm output function (Y). Lists various alarm settings like Deviation upper/lower limit, Absolute value upper/lower limit, etc.

Conformance to EN/IEC Standards

This is a Class A product. In residential areas it may cause radio interference, in which case the user may be required to take adequate measures to reduce interference.

Conformance to Safety Standards

Reinforced insulation is provided between input power supply, relay outputs, and between other terminals.

Minor injury due to electric shock may occasionally occur. Do not touch the terminals while power is being supplied. Electric shock, fire, or malfunction may occasionally occur.

Suitability for Use

OMRON shall not be responsible for conformity with any standards, codes, or regulations that apply to the combination of the products in the application or use of the product.

Installation

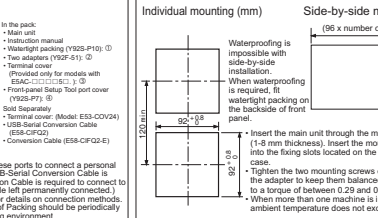

Operation indicators: No. 1 display, No. 2 display, No. 3 display, Shift key (PF key), Up and Down keys. Includes STOP: control stop indicator and Run/Stop indicator.

Precautions for Safe Use

- 1) The product is designed for indoor use only. Do not use the product outdoors. Do not use or store the product in any of the following locations: Places directly subject to heat radiated from heating equipment, Places subject to direct sunlight, Places subject to corrosive gas, etc.

Connections

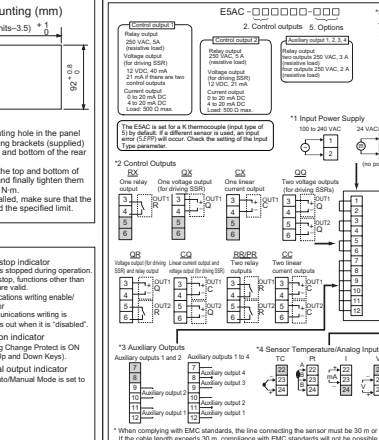

Specifications

- Power supply voltage: 100-240 VAC, 50/60 Hz, 24 VDC, 50/60 Hz / 24 VDC. Operating voltage range: 100-240 VAC, 50/60 Hz. Power consumption: 7.0 VA max. (100 to 240 VAC).

POWER ON

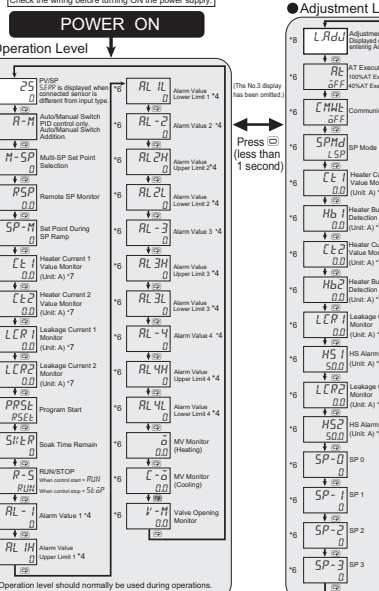

Adjustment Level

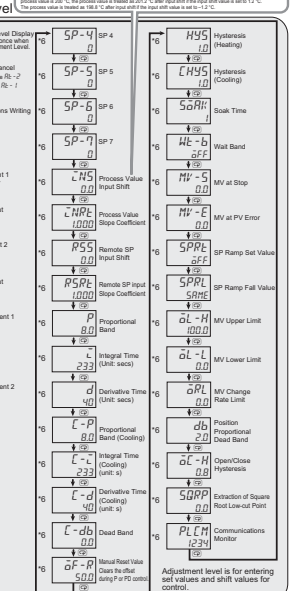

Protect Level

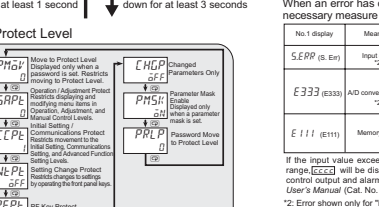

Error Display (troubleshooting)

Table with columns: No. 1 display, Meaning, Action, Control output, Alarm. Lists error codes like S.E.P.F. (S.P.F.), E.333 (E.333), E.111 (E.111), etc.

OMRON EUROPE B.V. Wageningen 67-69, NL-2132 JD Hoofddorp The Netherlands. Phone 31-2356-81-300. FAX 31-2356-81-388.